

VTUBE LASER

The power of
LASER



FIXTURING SOLUTION

Use the VTube-LASER tube clamp system to hold tube and pipe from 1/8 inch(3mm) up to 6 inch (150mm). (The clamps shown here are the 2.5 inch model.)

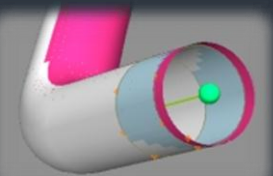

Tube Clamp

SYSTEM FOR VTUBE LASER



- The tube clamp uses a quick clamping system for temporary tube fixturing.
- Heavy and stable base
- Easy to hold pillar
- Ball and socket joint
- Plastic covered T-handle for better handling
- Quick spin close and open
- Industrial-grade glossy black finish
- 12 inch (300mm) overall height
- Non-slip cork bottom



 **ADVANCED
TUBULAR**
TECHNOLOGIES, INC.

FARO

Tube clamp sizes available:
1.0 inch, 2.5 inch, 4.5 inch, 6.0 inch

www.faro.com
www.advancedtubular.com